 <b>The Community Foundation</b> <small>Investing in the future of the communities we serve</small>	<b>2015 S.L. Gimbel Foundation Fund Grant Application</b>	Internal Use Only: Grant: <u>20150635</u>

### Organization / Agency Information



Organization/Agency Name: <u>Corona Norco Rescue Mission</u> <u>Inland Empire Rescue Mission</u> <span style="float: right;">19572</span>		
Physical Address: 420 West Harrison Street Corona CA 92880 City/State/Zip		
Mailing Address: same		City/State/Zip
CEO or Director: Blake Ryan		Title: Director
Phone: 951-493-2092	Fax:	Email: Blake.Ryan@rescuemission.org
Contact Person: Pamela Coles		Title: Foundation and Corporate Gifts Officer
Phone: 714-247-4308	Fax:	Email: Pamela.Coles@rescuemission.org
Web Site Address: www.rescuemissioncn.org		Tax ID: 27-0230701

### Program / Grant Information

Interest Area:  Animal Protection  Education  Environment  Health  Human Dignity

Program/Project Name: <u>Corona-Norco Rescue Mission Meal Program for Unsheltered and Sheltered Homeless Persons</u>			Amount of Grant Requested: <u>\$25,000</u>
Total Organization Budget: \$838,349	Per 990, Percentage of Program Service Expenses (Column B / Column A x 100): <u>89%</u>	Per 990, Percentage of Management & General Expenses Only (Column C / Column A x 100): <u>6%</u>	Per 990, Percentage of Management & General Expenses and Fundraising (Column C+D / Column A x 100): <u>5%</u>
Purpose of Grant Request (one sentence): <u>The purpose of the grant request is to provide funding for the Corona Norco Rescue Mission's feeding program for sheltered (transitional housing) and unsheltered homeless men, women and children.</u>			

### Signatures

Board President / Chair: (Print name and Title) <u>Jim Palmer, President</u>	Signature: 	Date: <u>3/3/2015</u>
Executive Director/President: (Print name and Title) <u>Blake Ryan, CNRM Director</u>	Signature: 	Date: <u>3/3/2015</u>

# 2015 S.L. GIMBEL FOUNDATION FUND APPLICATION NARRATIVE

## 1. Organization Background: Target Population.

### A. History

The Corona Norco Rescue Mission (CNRM) opened in June 2010 as a subsidiary of the Orange County Rescue Mission. CNRM formerly operated as the "Circle of Hope" emergency homeless shelter with some beds allocated for longer-term stays. Upon becoming a subsidiary program of the Orange County Rescue Mission, the focus purposefully shifted from overnight or emergency shelter to transitional housing, which addresses the root causes of homelessness over a period of time (18 to 24 months). Corona Norco Rescue Mission has a separate 501 (c) (3) exemption and is a program of the Inland Empire Rescue Mission.

### B. Organizational Accomplishments

The Corona Norco Rescue Mission underwent extensive remodeling prior to reopening the shelter to increase functionality of space to serve the needs of clients and improve the appearance of the facility in the community. The redesigned facility now has a 53 bed capacity for transitional housing for homeless men, women and children. Corona Norco Rescue Mission also operates **Hope Family Housing**, a 12-plex supportive housing project at 925 W. 5<sup>th</sup> Street in Corona. Hope Family Housing provides a final phase of transition for homeless individuals or families that are at or below 50% of median income. Supportive services are provided. In 2014, CNRM started **"Restoration Roasters"**, a nonprofit coffee shop enterprise on the campus of Crossroads Christian Church. The coffee shop is operated by Corona Norco's transitional housing residents as part of the vocational training program. Residents have the opportunity to receive training as a barista, gain experience working with the public and in business operations. All of the net proceeds from coffee sales go to support CNRM.

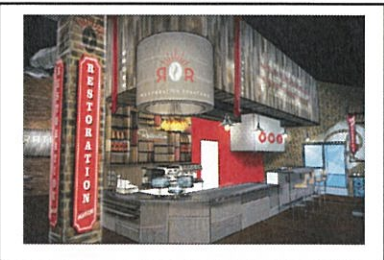

### C. Key Program and Activities

The CNRM transitional housing program provides homeless men, women and children with a structured 18 to 24 month "back-to-work" program. The residents receive meals, shelter, case management, alcohol/addiction recovery services, anger-management education, job readiness and job search activities, parenting instruction and counseling services. Residents are also linked to external social services, as needed. In FY 2013-14, 62 families or individuals received transitional housing services. CNRM also operates a nightly feeding program for unsheltered homeless or low income men, women and children. In FY 2013-2014, 22,800 meals were provided to residents of the program and to the homeless or poor in the community.



## II. Project Information

### A). Statement of Need

The 2013 Point in Time Survey (PIT) of the Homeless identified 2,978 homeless persons in Riverside County; 27% of participants were unsheltered and 13% were children (both sheltered and unsheltered). The 2011 Census Bureau reports that 14% of county residents live below poverty level; many of these households are at risk of becoming homeless should a catastrophic life event occur. Nearly one in four children resided in poverty in 2012, and 62% of children in Riverside County are eligible for the free or reduced lunch program through the Federal Government.

### B). Project Goal

1). The "County of Riverside 10 Year Strategy to End Homelessness" Strategic Report recommends 18 strategies to assist in eliminating homelessness. One of these strategies includes the creation of 75 transitional shelter units (an additional 225 transitional beds) with accompanying case management services. The Strategic Report continues: *"Families need longer periods of residency than the average shelter residency of 90 days in order to establish the resources to obtain and maintain permanent housing."* CNRM has responded to this need by providing an additional 52 transitional housing beds with supportive services for homeless men, women and children for an 18 to 24 months period (configuration: 14 beds for single men, 16 beds for single women, (2) rooms/10 beds for intact families, (3) rooms/12 beds for single moms).

#### 2). Project Objectives

**Objective 1:** Increase housing stability for homeless populations.

**Activities:** Provide transitional housing for a period of up to 24 months.

**Objective 2:** Increase food sufficiency for homeless and poverty populations.

**Activities:** Provide three nutritious meals daily for residents of the transitional housing program; provide one hot meal daily for non-sheltered homeless or poverty populations.

**Objective 3:** Increase self-sufficiency among homeless residents

**Activities:** Provide case management, life skills (budgeting, parenting) and job training and job search resources for program residents.

**Timeline:** These activities will be implemented over the course of the grant year.

#### 3). Target Population

Funds will be used to purchase food for the homeless residents of the transitional housing program and for the nightly feeding program for homeless and poverty populations.

**Projected age distribution:** Ages 0-6: 11%; Ages 7-17: 8%; Ages 18-24: 7%; Ages 25-39: 50%; Ages 40-64: 22%; Ages 65 and up: 2%.

#### 4). Existing projects and community partners

Lutheran Social Services, located in Riverside, offers transitional housing to women with children; Operation Safe House (youth), Path of Life (emergency shelter and transitional) and other non-profits serving the homeless in Riverside County. Community Partners include: United Way, Lennar Homes, Sam's Club, Home Depot, Church at the Mission-Corona, Crossroads Church, Saddleback Church Corona, Calvary Chapel, First Baptist Church, and TJMax.

### C). Project Outcomes and Evaluations

**Outcome 1: 48 homeless households will be provided with transitional housing.**

**Evaluation:** Staff will track the number of persons entering/exiting the CNRM program.

**Outcome 2: 16,891 meals will be provided (transitional program and nightly feeding program at the cost of \$1.48 per meal).**

**Evaluation:** Staff will track the number of meals served.

**Outcome 3: 35 homeless households will receive case management and wrap around supportive services.**

**Evaluation:** Staff will track resident's use of program services.

**D). Use of Funds:** Funds will be used to purchase food for the transitional housing program and the nightly feeding program for unsheltered and poverty populations.

### III. Project Future

Strategies to maintain fiscal stability include direct mail targeted to Riverside County donors, development of church and corporate partners, grants from Foundations and Corporations, and implementation of services from Plain Joe, a communications and brand development resource. The Orange County Rescue Mission currently provides CNRM assistance with administrative costs (finance, fundraising, human resources) and is committed to ensuring a continuation of services.

### IV. Governance, Executive Leadership and Key Personnel/Staff Qualifications

**CNRM Board of Directors:** The 10 member Board of Directors provides fiscal oversight of the Rescue Mission's various programs, including those located in the Inland Empire.

**Jim Palmer, President,** has been President of the Orange County Rescue Mission for 23 years and President of the CNRM since its inception. Mr. Palmer is responsible for oversight of seven core programs in Orange County, a recovery program for men in Warner Springs and three programs in the Inland Empire.

**Blake Ryan, Volunteer Director** of CNRM is currently a Partner and Managing Principal for PlainJoe Studios, an award winning design firm located in Corona, CA. His core responsibilities include leading a team of 40 employees, championing creative collaboration and solutions and managing a multi-million dollar budget. Prior to PlainJoe, Blake served as an executive for various non-profit organizations overseeing areas of finance, marketing and information technology. Blake is also a teaching Pastor of Church at the Mission Corona and Founder of Restoration Roasters.

**Charles Roberson, Manager of the Inland Empire Rescue Mission,** is a retired executive with IBM. His management experience includes marketing, finance, and project introduction for international markets and the U.S. Mr. Roberson co-managed a project that helped train underprivileged youth for IBM and the City of Atlanta, GA. He received IBM's Vice Presidential Award and a "Commendation of Merit" from the Mayor of Atlanta for his work on this project.



V. Project Budget: Corona Norco Rescue Mission

Line Item Description	Line Item Explanation	Support from Your Agency	Support From Other Funders	Requested Amount from TCF	Line Item Total of Project
Food	Cost for 35,844 meals	\$15,500	\$12,550	\$25,000	\$53,050
<b>Totals</b>		<b>\$15,500</b>	<b>\$12,550</b>	<b>\$25,000</b>	<b>\$53,050</b>

Cost per meal: \$1.48

Costs include meals for transitional housing program residents and for nightly homeless feeding program.

VI. Sources of Funding: Please list your current sources of funding and amounts.

*Secured/Awarded*

<i>Name of Funder: Foundation, Corporation, Government</i>	<i>Amount</i>
<i>United Way (balance of grant through June 2015; March payment counted)</i>	<i>\$4,250</i>
<i>Lennar Charitable Housing</i>	<i>\$3,000</i>
<i>TJX Foundation</i>	<i>\$5,000</i>
<i>Walmart</i>	<i>\$300</i>
<i>Total</i>	<i>\$12,550</i>

*Pending*

<i>Name of Funder: Foundation, Corporation, Government</i>	<i>Amount</i>
<i>No grants pending at this time; we will reapply to United Way, if invited.</i>	

Diversity of Funding Sources:

Funding Source	Amount	%	Funding Source	Amount	%
Contributions	\$83,000	10%	Program Fees	\$112,728	13%
Fundraising	\$89,000	11%	Interest Income		
Corp/Foundation Grants	\$69,000	8%	Other: Restoration Roasters	\$328,590	39%
Government Grants			Other: Support from Parent Company	\$155,431	19%

VII: Financial Analysis

Agency Name: Corona Norco Rescue Mission

Most Current Fiscal Year (Dates): From: **October 1, 2014** To: **September 30, 2015**

This section presents an overview of an applicant organization’s financial health and will be reviewed along with the grant proposal. Provide all the information requested on your **entire organization**. Include any notes that may explain any extraordinary circumstances. Information should be taken from your most recent 990 and audit. **Double check your figures!**

**Form 990, Part IX: Statement of Functional Expenses:**

**Most recent 990 (2012)**

1) Transfer the totals for each of the columns, Line 25- Total functional expenses (page 10)

Total Expenses	Program Services Expenses	Management & general expenses	Fundraising expenses
✓ \$1,183,436	✓ 1,051,048	✓ \$76,836	✓ \$55,552

2) Calculate the percentages of Columns B, C, and D, over A (per totals above)

- Program services (B) – A general rule is that at least 75% of total expenses should be used to support programs
- Management & general administration (C) – A general rule is that no more than 15% of total expenses should be used for management & general expenses
- Fundraising (D) – A general rule is that no more than 10% of total expenses should be used for fundraising

Total Expenses	Program Services Expenses	Management & general expenses	Fundraising expenses
\$1,183,436	✓ 89%	✓ 6%	✓ 5%
Must equal 100%	Must equal 100%	Must equal 100%	Must equal 100%

3) Calculate the difference between your Current year budget for management & general expenses and your previous management & general expenses per your 990 (Column C)

4)

Percentage of Organizations Current Total budget used for Administration (from cover page) 6%	Column C, Management & general expenses per 990 above 6%	Differential
		0

If the differential is above (+) or below (-), 10%, provide an explanation:

**Quick Ratio:** Measures the level of liquidity and measures only current assets that can be quickly turned to cash. A generally standard Quick Ratio equals 1 or more.

<b>Cash</b>	<b>+ Accounts Receivables</b>	<b>/Current Liabilities</b>	<b>= Quick Ratio</b>
\$22,628	\$4,442	21,756	1.24

**Excess or Deficit for the Year:**

<b>Excess or (Deficit)</b>	<b>Excess or (Deficit)</b>
<b>Most recent fiscal year end</b>	<b>Prior fiscal year end</b>
\$554,931	\$(327,593)

Notes:

VIII. Application submission check list:

**Submit 4 copies: 1 with original signatures and 3 copies, collated and stapled together**

**Submit 1 COPY**

- Completed Grant Application Form
- Cover sheet, narrative, budget and sources of funding, financial analysis page
- Board Member List
- Current operating budget and previous year's actuals
- Part IX only of the 990 form, Statement of Functional Expenses
- Copy of most recent final report

**501 (c) 3**

**A copy of most recent year-end audited statements (double-sided)**  
**A copy of your most recent 990 (double-sided)**

## Board Member Roster FY 2015

<b>Name</b>	<b>Vocation</b>	<b>Address</b>	<b>Phone</b>	<b>Position</b>	<b>Term</b>
Dr. Steve Callahan	Medical Doctor	One Hope Drive, Tustin California 92782	714-247-4301	Board Member	2013 - 2016 (A)
Mr. Mark Conzelman	Developer	One Hope Drive, Tustin California 92782	714-247-4301	Board Member	2012 - 2015 (C)
Dr. Ralph Duff	Consultant	One Hope Drive, Tustin California 92782	714-247-4301	Board Member	2013 - 2016 (A)
Mr. Chris Ferebee, Esq.	Attorney	One Hope Drive, Tustin California 92782	714-247-4301	Board Member	2014 - 2017 (B)
Dr. Bill Guard	Dentist	One Hope Drive, Tustin California 92782	714-247-4301	Board Member	2013 - 2016 (A)
Rev. Bart Hansen	Ministry	One Hope Drive, Tustin California 92782	714-247-4301	Chairman	2012 - 2015 (C)
Mrs. Jackie Nowlin	Volunteer	One Hope Drive, Tustin California 92782	714-247-4301	Board Member	2014 - 2017 (B)
Mr. Joe Oltmans	Construction	One Hope Drive, Tustin California 92782	714-247-4301	Board Member	2014 - 2017 (B)
Mr. Jim Palmer	OCRM President	One Hope Drive, Tustin California 92782	714-247-4301	President	ongoing



# Inland Empire Rescue Mission

## FY 2014 Actual/Budget vs. FY 2015 Forecast - Income and Expense Report

	FY 2014 (10/13-9/14 Actual)	FY 2015 Forecast (Oct 14 to Sept 15)	Change \$	Change %
<b>Operational Cash Income</b>				
000-4202 Major Donors	\$ 115,460	\$ 83,000	\$ (32,460)	-28%
000-4203 Foundations	\$ 84,250	\$ 69,600	\$ (14,650)	-17%
000-4204 Direct Mail	\$ 79,978	\$ 89,000	\$ 9,022	11%
000-4500 Rental Income / Program Fees	\$ 59,147	\$ 112,728	\$ 53,581	91%
Restoration Roasters Revenue	\$ 4,337	\$ 328,590	\$ 324,253	100%
Support from Parent Company **	\$ 2,377,948	\$ 155,431	\$ (2,222,517)	
Sub total Operational Cash Income	\$ 2,721,120	\$ 838,349	\$ (1,882,771)	-69%

	FY 2014 (10/13-9/14 Actual)	FY 2015 Budget (Oct 14 to Sept 15)	Change \$	Change %
<b>Operational Cash Expenses</b>				
000-5030+5031 Audit & Financial Service Fees	\$ 8,353	\$ 8,300	\$ (53)	-1%
000-5040-5060 Auto Expense	\$ 6,113	\$ 7,380	\$ 1,267	21%
000-5090 Benevolence & Student Emergencies	\$ 2,397	\$ 2,176	\$ (221)	-9%
000-5100 Clothing & Personal Care & Linens	\$ 3,257	\$ 4,675	\$ 1,418	44%
000-5122 General Monthly Appeal Letters	\$ 4,022	\$ 5,500	\$ 1,478	37%
000-5130 Donor Acquisition	\$ 33,243	\$ 41,000	\$ 7,757	23%
000-5136 Newsletter	\$ 1,323	\$ 1,328	\$ 5	0%
000-5155 Information Technologies	\$ 42,432	\$ 3,250	\$ (39,182)	-92%
000-5165 Education Materials	\$ 131	\$ 1,200	\$ 1,069	816%
000-5180 Food	\$ 56,952	\$ 53,050	\$ (3,902)	-7%
000-5225-5230 Human Resources & Liability Insurances	\$ 11,802	\$ 10,725	\$ (1,077)	-9%
000-5285 Licenses & Taxes	\$ 6,874	\$ 6,350	\$ (524)	-8%
000-5290+5413 Facility Maintenance Cost	\$ 37,785	\$ 54,535	\$ 16,750	44%
000-5315 Organizational Membership Dues	\$ 620	\$ 400	\$ (220)	-35%
000-5480 Salaries, Payroll Taxes, Health Insurance	\$ 484,414	\$ 268,075	\$ (216,339)	-45%
000-5510 Tiered Services	\$ -	\$ 2,300	\$ 2,300	100%
000-5515 Staff Training	\$ 209	\$ 250	\$ 41	100%
000-5530 Supplies & Program Materials	\$ 11,273	\$ 10,125	\$ (1,148)	-10%
000-5540 Utilities	\$ 44,663	\$ 49,140	\$ 4,477	10%
000-5700+5701 Contract Labor	\$ 38,354	\$ -	\$ (38,354)	-100%
000-5540 Restoration Roasters Expenses	\$ 1,403	\$ 308,590	\$ 307,187	100%
Sub total Operational Cash Expenses	\$ 795,620	\$ 838,349	\$ 42,729	5%

Net increase in cash over expenses \$ 1,925,500 \$ (1,925,500)

Support from Parent Company \*\*

\$1,740,988 for previous years

\$636,960 for current year

**Part IX Statement of Functional Expenses**

Section 501(c)(3) and 501(c)(4) organizations must complete all columns. All other organizations must complete column (A).

Check if Schedule O contains a response to any question in this Part IX

Do not include amounts reported on lines 6b, 7b, 8b, 9b, and 10b of Part VIII.	(A) Total expenses	(B) Program service expenses	(C) Management and general expenses	(D) Fundraising expenses
1 Grants and other assistance to governments and organizations in the United States. See Part IV, line 21 . . . . .				
2 Grants and other assistance to individuals in the United States. See Part IV, line 22 . . . . .	534,064.	534,064.		
3 Grants and other assistance to governments, organizations, and individuals outside the United States. See Part IV, lines 15 and 16 . . . . .				
4 Benefits paid to or for members. . . . .				
5 Compensation of current officers, directors, trustees, and key employees . . . . .	110,679.	110,679.	0.	0.
6 Compensation not included above, to disqualified persons (as defined under section 4958(f)(1)) and persons described in section 4958(c)(3)(B). . . . .				
7 Other salaries and wages. . . . .	190,994.	150,851.	23,472.	16,671.
8 Pension plan accruals and contributions (include section 401(k) and section 403(b) employer contributions). . . . .	6,000.	6,000.	0.	0.
9 Other employee benefits . . . . .	37,658.	32,758.	2,700.	2,200.
10 Payroll taxes . . . . .	31,255.	28,185.	1,795.	1,275.
11 Fees for services (non-employees):				
a Management . . . . .	33,523.	0.	33,523.	0.
b Legal . . . . .	617.	0.	617.	0.
c Accounting . . . . .	8,260.	0.	8,260.	0.
d Lobbying . . . . .				
e Professional fundraising services. See Part IV, line 17 . . . . .				
f Investment management fees . . . . .				
g Other. (If line 11g amt exceeds 10% of line 25, column (A) amt, list line 11g expenses on Sch O) . . . . .				
12 Advertising and promotion . . . . .	34,890.	0.	1,592.	33,298.
13 Office expenses . . . . .	9,559.	9,559.	0.	0.
14 Information technology . . . . .	18,947.	15,802.	2,027.	1,118.
15 Royalties . . . . .				
16 Occupancy . . . . .	50,972.	50,972.	0.	0.
17 Travel . . . . .				
18 Payments of travel or entertainment expenses for any federal, state, or local public officials . . . . .				
19 Conferences, conventions, and meetings . . . . .				
20 Interest . . . . .				
21 Payments to affiliates. . . . .				
22 Depreciation, depletion, and amortization . . . . .	105,926.	102,218.	2,765.	943.
23 Insurance . . . . .	1,477.	1,477.	0.	0.
24 Other expenses. Itemize expenses not covered above (List miscellaneous expenses in line 24e. If line 24e amount exceeds 10% of line 25, column (A) amount, list line 24e expenses on Schedule O.) . . . . .				
a <u>Vehicles</u> . . . . .	6,966.	6,966.	0.	0.
b <u>Dues &amp; Training</u> . . . . .	1,649.	1,517.	85.	47.
c . . . . .				
d . . . . .				
e All other expenses . . . . .				
25 Total functional expenses. Add lines 1 through 24e. . . . .	1,183,436.	1,051,048.	76,836.	55,552.
26 Joint costs. Complete this line only if the organization reported in column (B) joint costs from a combined educational campaign and fundraising solicitation. Check here <input type="checkbox"/> if following SOP 98-2 (ASC 958-720). . . . .				



 <b>The Community Foundation</b>	<b>S.L. Gimbel Foundation Fund Grant Evaluation Form</b>
<b>Grant Period:</b>	

Organization: Inland Empire Rescue Mission Inc.

Contact Name: Lisa Jones

Title: Grants Writer

Phone Number: 714-247-4305

Grant Period: Feb. 1, 2014 - Jan. 31, 2015

Award Amount: \$25,000

Grant Number: 20130986

- **Describe the project’s key outcomes and results based on your goals and objectives. Provide the number of clients served and other relevant statistics.**

**Key Outcome 1:** 48 homeless households will be provided with transitional housing.

Results: Occupancy in our transitional housing program during the grant period fluctuated between 60% and 80%, averaging 70% or higher over the last 4 months. Our family rooms are consistently occupied serving homeless children and their parents. The program’s retention rate is about 60%.

**Key Outcome 2:** 25,000 meals will be provided (transitional program and nightly feeding program).

Results: On average, 1,900 meals were served monthly, inclusive of the population referenced in the report (clients in our transitional housing program and homeless and extremely low-income persons who come in off of the street for a meal). This translates into 22,800 meals, which is 91% of the projected outcome.

**Key Outcome 3:** 35 homeless households will receive case management and wrap around supportive services (14 single men/16 single women/2 intact families/3 single moms).

Results: 62 families and/or individuals received services through our program.

- **What were the challenges and obstacles you encountered (if any) in attaining your goals & objectives? How did you overcome and/or address the challenges and obstacles? What were the lessons learned?**

**Challenge:** One of the biggest challenges for the homeless persons entering our program is learned behavior, not wanting to give up habits that contributed to their homelessness. Learned behavior can affect their response to case management, wraparound services, and ultimately how long they stay in the program (affecting outcome 3).

**How We Address It:** Learned behavior, while a significant challenge, is not a new obstacle to the program. The Corona Norco Rescue Mission addresses clients’ learned behaviors through recovery initiatives like ‘Celebrate Recovery,’ anger management education, parenting instruction, counseling, and case management services. Addressing negative learned behaviors helps our clients proactively deal with the root causes of their homelessness and learn new behaviors so they do not fall into old habits.

**Challenge:** One of the other challenges is clients’ imagining that a new, breakthrough job is going to come through in the near-term that will solve all their problems. When the job is not immediately forthcoming, or they see too many obstacles between them and their goal, it can affect their progress in

the program or cause their exit (affecting outcomes 1, 2, and 3), deciding that they can better address their issues from the streets or other unstable living situations.

**How We Address It:** We address clients' occasional fixation on a 'cure-all' job by not pushing clients into a job search until they are stable and progressing in the program (9-12 months depending on progress on their 'Individualized Treatment Plan' with their case manager). It is important that negative learned behaviors are addressed to prevent them from affecting the client's employability or personal life. When clients do enter the job search phase, they participate in job readiness workshops, personal presentation mock interviews, and financial education workshops.

- **Describe any unintended positive outcomes as a result of the efforts supported by this grant.**

Connections with staff can lead to entrance into the transitional housing program or even provide the impetus some chronically homeless individuals need to make a change. Due to the transience of the population, unintended positive outcomes are hard to narrow down. The meals served at the nightly feedings keep dozens of Corona's homeless from going hungry or finding more desperate ways of obtaining food. The nightly meals for the homeless community also provide a safe place for these people to simply rest for a few hours.

- **Describe the overall effect this grant has had on your organization.**

The Gimbel Foundation graciously provided our largest grant during FY 2014-2015, which allowed us to continue our core programs and expand into new territories (using other funds). The Gimbel Foundation's grant allowed us to act as a beacon in our community and motivate other community groups to follow suit, such as the Corona Police Department and Veg-Fresh Farms, which are our partners.

Since 2009, the Corona Norco Rescue Mission has provided services to the homeless and extremely low-income persons and families of Corona. In 2014, we also launched a nonprofit coffee shop initiative ('Restoration Roasters') funded by a mix of Indiegogo donors and other generous sources. Through this initiative, our transitional housing clients develop barista skills and interact with the community as part of their program. The Gimbel Foundation's 2014-2015 funded food costs at our core transitional housing and nightly feeding program. Having our core costs funded put us in a stable position to consider the coffee shop initiative and dynamically act on the opportunity.

The Gimbel Foundation grant fulfilled our objectives in the following ways:

- Objective 1. Increase housing stability for homeless populations

**Issue:** Riverside County as a whole struggles with poverty, as well as high unemployment rates throughout the past seven years. There are few shelters in the area and even fewer which accept families, single parents, and individuals. Homelessness can often result in family fragmentation, as some members of a family are able to enter a shelter and others are ineligible.

**What we're doing:** The Corona Norco Rescue Mission is able to shelter and preserve whole families, thanks to generous private donors like the S.L. Gimbel Foundation. Meals are a pillar of any transitional housing program to help individuals and families remain in the program and feel stable.

**Result:** By making meals accessible to 35 families in our transitional housing program, Foundation funds increased homeless persons and families' ability to stay in the program and pursue self-sufficiency.

- Objective 2. Increase food sufficiency for homeless and poverty populations



Department of the Treasury  
Internal Revenue Service

P.O. Box 2508  
Cincinnati OH 45201

In reply refer to: 0248651232  
Dec. 06, 2010 LTR 4168C E0  
27-0230701 000000 00  
00018124  
BODC: TE

INLAND EMPIRE RESCUE MISSION INC  
% JIM PALMER  
1 HOPE DR  
TUSTIN CA 92782



012696

Employer Identification Number: 27-0230701  
Person to Contact: Mr. Kelley  
Toll Free Telephone Number: 1-877-829-5500

Dear Taxpayer:

This is in response to your Nov. 24, 2010, request for information regarding your tax-exempt status.

Our records indicate that you were recognized as exempt under section 501(c)(3) of the Internal Revenue Code in a determination letter issued in October 2009.

Our records also indicate that you are not a private foundation within the meaning of section 509(a) of the Code because you are described in section(s) 509(a)(1) and 170(b)(1)(A)(vi).

Donors may deduct contributions to you as provided in section 170 of the Code. Bequests, legacies, devises, transfers, or gifts to you or for your use are deductible for Federal estate and gift tax purposes if they meet the applicable provisions of sections 2055, 2106, and 2522 of the Code.

Please refer to our website [www.irs.gov/eo](http://www.irs.gov/eo) for information regarding filing requirements. Specifically, section 6033(j) of the Code provides that failure to file an annual information return for three consecutive years results in revocation of tax-exempt status as of the filing due date of the third return for organizations required to file. We will publish a list of organizations whose tax-exempt status was revoked under section 6033(j) of the Code on our website beginning in early 2011.



0248651232  
Dec. 06, 2010 LTR 4168C E0  
27-0230701 000000 00  
00018125

INLAND EMPIRE RESCUE MISSION INC  
% JIM PALMER  
1 HOPE DR  
TUSTIN CA 92782

If you have any questions, please call us at the telephone number shown in the heading of this letter.

Sincerely yours,

*Michele M. Sullivan*

Michele M. Sullivan, Oper. Mgr.  
Accounts Management Operations I



Strengthening Inland Southern California through Philanthropy

*S. L. Gimbel Foundation Fund*

BOARD OF DIRECTORS

Philip Savage IV  
Chair of the Board

Sean Varner  
Vice Chair of the Board

Pat Spafford, CPA  
Chief Financial Officer

Sergio Bohon  
Secretary of the Board

Glenda Bayless

Dr. Paulette Brown-Hinds

Rabbi Hillel Cohn

James Cuevas  
Immediate Past Board Chair

Paul Granillo

Stanley Grube

Kirk Harns

Dr. Fred Jandt

Andrew Jaramillo

Dr. Albert Karnig

D. Matthew Pim

Teresa Rhyne

Dr. Henry Shannon

Tamara Sipos

Beverly Stephenson

Randall Tagami

Diane Valenzuela

Dr. Jonathan Lorenzo Yorba  
President and CEO

August 26, 2015

Mr. Blake Ryan  
Director  
Inland Empire Rescue Mission Inc  
Corona Norco Rescue Mission  
420 W. Harrison St.  
Corona, CA 92880

Dear Mr. Ryan:

Congratulations! A grant has been approved for **Inland Empire Rescue Mission Inc** in the amount of **\$25,000** from the S.L. Gimbel Foundation. The **performance period for this grant is September 1, 2015 to August 31, 2016**. Additional funding beyond the performance period is not guaranteed. It is highly recommended that alternative funding sources be sought accordingly. The grant is to support the following as specified in your proposal:

*Meal Program for Unsheltered and Sheltered Homeless Persons: To feed sheltered (transitional housing) and unsheltered homeless men, women and children.*

This grant is subject to the terms outlined in the enclosed Grant Agreement. After you have reviewed the terms and conditions of the Grant Agreement, please sign and date the enclosed copy and return the original copy to The Community Foundation within the next two weeks. Please retain a copy of the signed agreement for your records. Funds will be released upon receipt of the signed Grant Agreement.

A condition of this grant is that you agree to submit the Grant Evaluation Form which includes a narrative report and fiscal report. The **Grant Evaluation is due by September 15, 2016** and a copy will be available online.

We wish you great success and look forward to working with you during the grant performance period.

If you have any questions, please call me at 951-684-4192 ext. 114 or email me at [ccudiamat@thecommunityfoundation.net](mailto:ccudiamat@thecommunityfoundation.net).

Sincerely,

Celia Cudiamat  
Executive Vice President of Programs

18572 Inland Empire Rescue Mission Inc

20150635

GIMB4



Confirmed in Compliance  
with National Standards for  
U.S. Community Foundations

3700 Sixth Street, Suite 200 Riverside, California 92501  
P: 951.241.7777 F: 951.684.1911 [www.thecommunityfoundation.net](http://www.thecommunityfoundation.net)





September 15, 2015

Ms. Celia Cudiamat  
Executive Vice President of Programs  
3700 Sixth Street, Suite 200  
Riverside, CA. 92501

RE: Grant Agreement 20130635

Dear Ms. Cudiamat,

On behalf of the Board of Directors of the Inland Empire Rescue Mission, I wish to thank the S.L. Gimbel Foundation for the grant of \$25,000 in support of meals for sheltered and unsheltered homeless populations at our Corona-Norco Rescue Mission.

Riverside County, while recovering from the recession, still has 16.2% of its population living at or below 100% of the Federal Poverty Level and nearly 25% of all children live in food insecure households. These individuals and families are at-risk to homelessness, should a catastrophic life event occur, such as illness, loss of job or an eviction.

The Corono-Norco Rescue Mission provides a safe place for individuals and families that are homeless to restore their lives. The Rescue Mission provides case management, job training, counseling, personal development and meets basic needs such as shelter, meals, and health care referrals.

For the chronically homeless in the area, the Rescue Mission offers a nightly hot meal in a warm and friendly environment. Our desire is to not only feed the homeless but to also reach out to those who may choose to enter the transitional housing program.

Again, we are so appreciative of this support. Your generosity will enable us to provide nutritious meals to homeless individuals and families. I have enclosed the signed grant agreement.

Sincerely,



Jim Palmer  
President

JP:pc



## 2015 S.L. Gimbel Foundation Fund

### Grant Agreement

**Organization:** Inland Empire Rescue Mission Inc

**Grant Amount:** \$ 25,000 **Grant Number:** 20150635

**Grant Period:** September 1, 2015 to August 31, 2016 (Evaluations due by September 15, 2016)

**Purpose:** Meal Program for Unsheltered and Sheltered Homeless Persons: To feed sheltered (transitional housing) and unsheltered homeless men, women and children.

#### 1. Use of Grant Funds

Grant funds must be expended within the grant period, for the purpose and objectives described in your grant proposal. Grant funds may not be expended for any other purpose without prior written approval by The Community Foundation. If there are significant difficulties in making use of the funds as specified in your proposal, or if the grant funds cannot be spent within the grant period, notify us in writing promptly.

Formal requests for extensions or variances must be submitted to the Foundation's Board of Directors for approval a minimum of 60 days before the end of the grant period.

Requests for variances or extensions are reviewed on a case-by-case basis and approved by the Board of Directors. If a request is denied, unused funds must be immediately refunded to the Foundation.

#### 2. Payment of Grant Funds

The grant funds will be paid in full by the Foundation upon receipt of the signed Grant Agreement. Challenge grant funds will be paid in full upon receipt of the signed Grant Agreement and upon receipt of documentation providing evidence that condition(s) of the challenge grant has/have been met.

#### 3. Certification and Maintenance of Exempt Organization Status

This grant is specifically conditioned upon Grantee's status as an eligible grantee of The Community Foundation. The Foundation has obtained a copy of the Grantee's IRS determination letter. Grantee confirms that it has not had any change in its tax-exempt status, and shall notify the Foundation immediately of any such change.

#### 4. Final Report and Records

The Grantee will submit the Grant Evaluation report per the deadline set forth in the award letter. This report includes a narrative on outcomes based on goals and objectives set forth in the grant proposal and an expenditure report documenting use of grant funds. If equipment was purchased, copies of receipts need to be included.

#### 5. Grantee's Financial Responsibilities

Grantee will keep records of receipts and expenditures of grant funds and other supporting documentation related to the grant at least four (4) years after completion of the grant and will make such records of receipts, expenditures and supporting documentation available to the Foundation upon request.

#### 6. Publicity

The Community Foundation recommends publicity for the grant and acknowledging The Community Foundation in internal correspondence, brochures as appropriate; newsletters, annual reports and email blasts or e-newsletters.

The credit line of "Made possible in part by a grant from the "S.L. Gimbel Foundation Advised Fund at The Community Foundation – Inland Southern California" is suggested. When your donors are listed in printed materials, include the S.L.

Gimbel Foundation Advised Fund at The Community Foundation in the appropriate contribution size category. When publishing our name, please note the "The" at the beginning of our name is a legal part of our name. It should always be used and capitalized. Attaching our logo is also appreciated. Our logo can be downloaded from our website at [www.thecommunityfoundation.net](http://www.thecommunityfoundation.net).

**7. Indemnification**

In the event that a claim of any kind is asserted against the Grantee or the Foundation related to or arising from the project funded by the Grant and a proceeding is brought against the Foundation by reason of such claim, the Grantee, upon written notice from the Foundation, shall, at the Grantee's expense, resist or defend such action or proceeding, at no cost to the Foundation, by counsel approved by the Foundation in writing.

Grantee hereby agrees, to the fullest extent permitted by law, to defend, indemnify, and hold harmless the Foundation, its offices, directors, employees, and agents, from and against any and all claims, liabilities, losses, and expenses (including reasonable attorneys' fees) directly, indirectly, wholly, or partially arising from or in connection with any act or omission by Grantee, its employees, or agents in applying for or accepting the Grant, in expending or applying the Grant funds or in carrying out any project or program supported by the Grant, except to the extent that such claims, liabilities, losses, and expenses arise from or in connection with any bad faith act or omission by the Foundation, its officers, directors, employees, or agent.

**8. Termination**

The Community Foundation may terminate this agreement, withhold payments, or both at any time, if, in the Community Foundation's judgment: a) The Community Foundation is not satisfied with the quality of the Grantee's progress toward achieving the project goals and objectives; b) the Grantee dissolves or fails to operate; c) the Grantee fails to comply with the terms and conditions of this agreement.

**9. Limitation of Support**

This Agreement contains the entire agreement between the parties with respect to the Grant and supersedes any previous oral or written understandings or agreements.

\*\*\*\*\*

**I have read and agree to the terms and conditions of the Grant Agreement.**

\_\_\_\_\_  
Signature  
*Blake Ryan*  
\_\_\_\_\_  
Printed Name

\_\_\_\_\_  
Date *9/1/2015*  
\_\_\_\_\_  
Title *Director*

Organization: 18572 Inland Empire Rescue Mission Inc  
Grant Number: 20150635

*9/22/15*

*RECEIVED 9/21/15*



Strengthening Inland Southern California through Philanthropy

BOARD OF DIRECTORS September 29, 2015

Philip Savage IV  
Chair of the Board

Sean Varner  
Vice Chair of the Board

Pat Spafford, CPA  
Chief Financial Officer

Sergio Bohon  
Secretary of the Board

Glenda Bayless

Dr. Paulette Brown-Hinds

Rabbi Hillel Cohn

James Cuevas  
Immediate Past Board Chair

Paul Granillo

Stanley Grube

Kirk Harns

Dr. Fred Jandt

Andrew Jaramillo

Dr. Albert Karnig

D. Matthew Pim

Teresa Rhyne

Dr. Henry Shannon

Tamara Sipos

Beverly Stephenson

Randall Tagami

Diane Valenzuela

Dr. Jonathan Lorenzo Yorba  
President and CEO

Mr. Blake Ryan  
Director  
Inland Empire Rescue Mission, Inc.  
Corona Norco Rescue Mission  
420 W. Harrison St.  
Corona, CA 92880

Dear Mr. Ryan:

The Community Foundation is pleased to enclose a grant check for \$25,000 from the S. L. Gimbel Foundation, a component fund at The Community Foundation. By cashing the grant check, you are agreeing to the conditions stated under the *Terms of Grant* which you have signed and returned. The completed Grant Evaluation form is due by September 15, 2016 and will be available online on The Community Foundations website under Grants/Forms. Please note that any grant variances or extensions must be requested in writing and in advance. Any remaining grant funds must be returned to The Community Foundation at the end of the grant period.

We greatly appreciate any help you can give us in publicizing the grant. Please use the following credit in any grant announcements or materials funded by the grant: "The (name of project/program) is supported by a grant from The S. L. Gimbel Foundation." You may send copies of articles printed in local papers, stories in your agency newsletter, annual report, press releases, and other publications for our files.

If you have any questions, please contact me at 951-241-7777.

Sincerely,

Celia Cudiamat  
Executive Vice President of Programs

20150635

39679

GIMB4



Confirmed in Compliance  
with National Standards for  
U.S. Community Foundations

3700 Sixth Street, Suite 200 · Riverside, California 92501  
P: 951.241.7777 · F: 951.684.1911 · www.thecommunityfoundation.net

**The Community Foundation**  
 Strengthening Inland Southern California through Philanthropy  
 3700 SIXTH STREET, SUITE 200  
 RIVERSIDE, CA 92501  
 951-241-7777 / FAX 951-684-1911

**CITIZENS BUSINESS BANK**  
 A Financial Services Company  
 3696 Main Street, Riverside, CA 92501  
 90-3414-1222

39679

PAY \* Twenty-Five Thousand and no/100 \*

TO THE ORDER OF

Inland Empire Rescue Mission Inc  
 Corona Norco Rescue Mission  
 420 W. Harrison St.  
 Corona, CA 92880

DATE 08/27/2015 AMOUNT \$\*\*\*\*25,000.00



*Jonathan Lorenzo Flores*  
*Chia Andriani*  
 AUTHORIZED SIGNATURE

Security features. Details on back.

⑈039679⑈ ⑆122234149⑆ 244124437⑈

The Community Foundation			39679
18572	Inland Empire Rescue Mission Inc	08/27/2015 039679	
20150635	08/25/2015 Meal Program for Unsheltered and Sheltered Homeless		25,000.00
GIMB	S.L. Gimbel Foundation Advised Fund	25,000.00	

CHECK TOTAL: \$\*\*\*\*25,000.00

The Community Foundation			39679
18572	Inland Empire Rescue Mission Inc	08/27/2015 039679	
20150635	08/25/2015 Meal Program for Unsheltered and Sheltered Homeless		25,000.00
GIMB	S.L. Gimbel Foundation Advised Fund	25,000.00	

CHECK TOTAL: \$\*\*\*\*25,000.00